

ROUND LED PANEL LIGHT SPECIFICATION



Introduction:

Richee Lighting's slim panel light utilize a die-casting aluminum alloy with a simple design. This panel light can change CCT from 3000K-6000K. It has three wires going out: one for positive, 3000K, and 6000K. You can use a CCT Tunable White controller to switch between color temperatures. Or set it to one color temperature by wiring either the 3000K or the 6000K wire to the negative of your 24VDC input wires. And you can also connect both 3000K and 6000K wires to the negative input wire for 4000K.

Main Features:

- ✧ High efficiency & energy saving. It saves more than 70% energy compared with a traditional lamp.
- ✧ Long life span, uses semiconductor chips as the light resource, the life hours can be over 30,000hrs.
- ✧ No UV & IR .
- ✧ Eco-friendly, No Hg & Xe, or other harmful elements. Recyclable, also it won't generate EMI.

Application:

Commercial Lighting
Residential Lighting
Office, Living Room Meeting Room,
Lobby, Hotel, Bank,
Super Market, Shopping Mall

Technical Parameters:

3010-CCT-24V

Input Voltage: DC 24V

Power Consumption: 12W

Lumen Output: 800±50LM

LED Chip: SMD 2835

CCT Adjustable (3000K~6000K)

Color Rendering Index: $Ra \geq 90$

Beam Angle: 120°

Dimmable: Yes

Product Size: $\varnothing 170 \times 12\text{mm}$

Cutout Size: $\varnothing 160\text{mm}$

Certificates: ETL, cETL

Warranty: 3 Years

Protection Class: IP21

Housing color: White

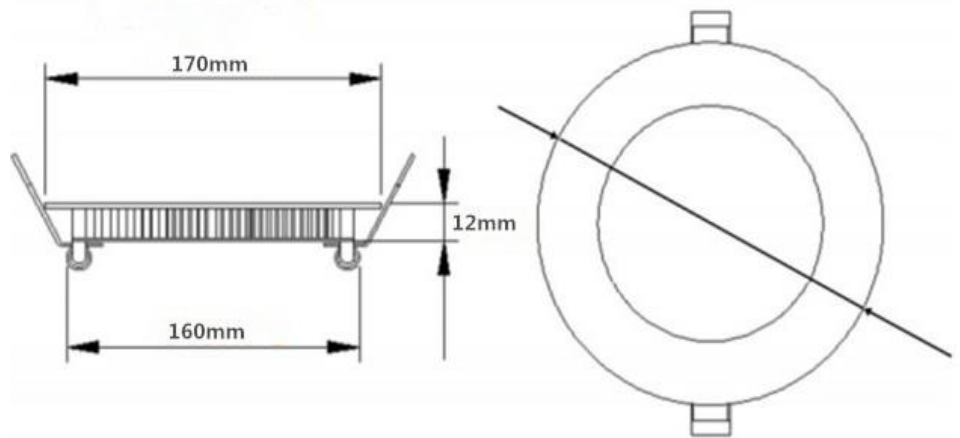

Quick and Easy Installation:

