



FEATURES

- Integrated fixture, easy installation, no trim and can required
- High quality aluminum heat sink, good heat dissipation
- 8 watts 700 lumens with high brightness COB light source
- Isolated constant current driver, works stable
- North American standard junction box inside, easy wiring
- New Generation led light with 360° rotation
- Free of harmful mercury, environment friendly
- 2700K 3000K 4000K 6000K color temperature for optional
- Suitable For Damp Location
- cETLus certification

INSTALLATION

- Risk of electric shock!
- Turn power off before installation and removal.
- Do not use other drivers.

Product Dimension

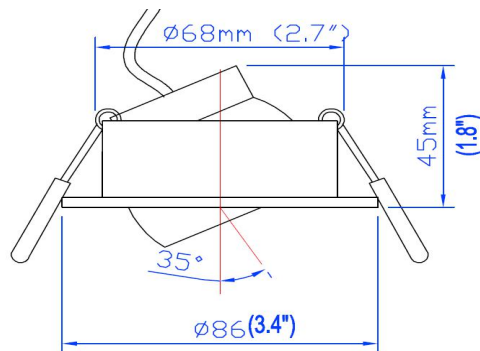

3" Gimbal LED Downlight

Item No.:	3005
Power:	8W
Input Voltage:	AC120V
Lumen Flux:	700lm ± 5%
LED Type:	COB LED (Chips On Board)
CRI:	RA80
Product Size:	Φ 86*45mm Cut-out size: Φ 68mm
Dimmable:	Yes
Beam Angle:	36°
PF:	>0.9
Lifespan:	35,000H
IC-rated:	Yes
Package	30pcs/ctn,37×45x38cm,
CCT	2700K: 3005-WWW-120V 3000K: 3005-WW-120V 4000K: 3005-NW-120V 6000K: 3005-CW-120V

DESIGN IDEA

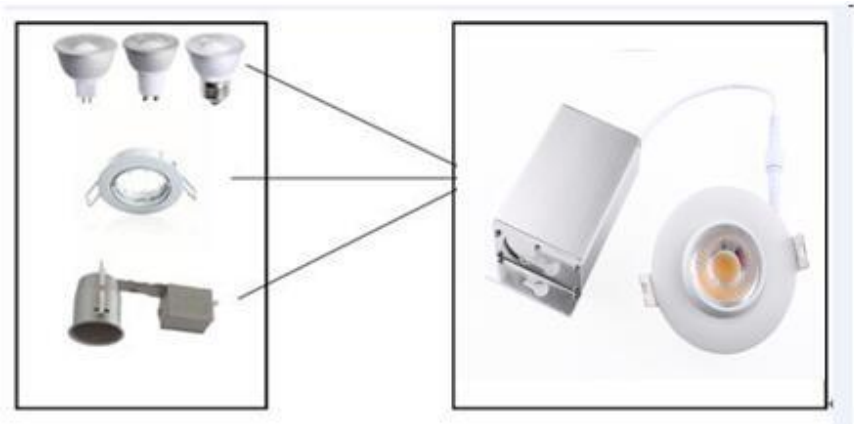



Angle Adjustable Recessed LED Lighting Fixture (3 Inch)



FEATURES

- IC-Rated
- Integrated fixture, easy installation, no trim and can required
- High quality cold forged aluminum heat sink, good heat dissipation
- 8 watts 750 lumens with high brightness COB light source
- Isolated constant current driver, works stable
- North American standard junction box inside, easy wiring
- Instant-on, no warm up time
- Free of harmful mercury, environment friendly
- 2700K to 6500K color temperature optional

CAUTIONS

- Rated for indoor use only; do not use where exposed to weather
 - Do not use other drivers
- Do not connect multiple fixtures to one driver

Specifications:

Item No.:	3005-XX-120V
Power:	8W
Input Voltage:	AC110/120V (50/60Hz)
Power Factor:	>0.95
LED Type:	COB
Color Temperature:	2700K/3000K/4000K/5000K/6000K
CRI:	>Ra80
Lumen Flux:	700-750lm (±5%)
Beam angle:	38 Degree
Dimmable:	Yes
Lifespan:	>25,000H
Working Temperature	-20~50℃

DRIVER

Driver type: Isolated constant current driver

Input voltage: 110/120V AC

Input current: 70mA

DESIGN IDEA

