

Product Specification

Part No:	5043-CCW-1.5W
Product:	LED Module With Lens
Feature:	2835 SMD LED. DC12V.175 Degree





1.Features:

- Good Heat Sink system. Low Brightness Decline. Span Life Up to 50,000hours
- ABS Base and Overall Lens
- Innovative Over molded Way Generate Finest China LED Module
- Double Faced Tape or Screw Hole to Make Installation Easier
- CE ROHS UL certificated

2.Application:

1. Illuminated Signage.

2. Light Box



3.Specification:

Photoelectric parameters

Part No	LED	color	Color temperature	Voltage (V)	Watt(W)	Lumen (LM)	Efficiency (LM/W)	View (°)
5043-CCW-1.5W	SMD2835	Cool white	9000k	12	1.5	132	88	175

Physical parameters

Series connection (PCS)	Cover material	Driver	Weight (g) 20pcs	Span life (Years)	Size (mm)	Working environment (°C)	IP
20	ABS	12V(cv)	0.29kg	3	77x15.9x7.8	-25-+70	IP65

Note: ① Test Condition $T_a=25\pm2^{\circ}\text{C}$; ② CV- constant voltage/CC-constant current

③ The mentioned data are typical. The real data are different from typical data.

4.Light Distribution and Light Diagram:

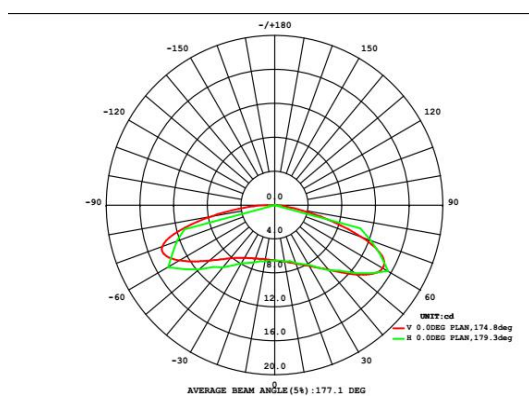

Light Distribution

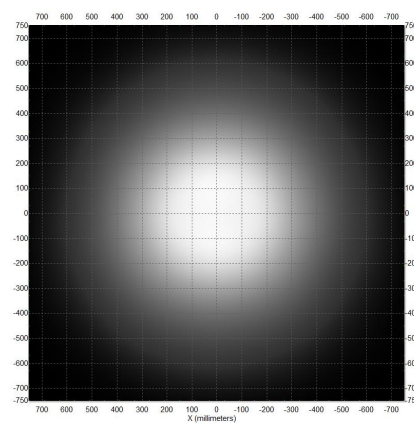

Light Diagram

5. Certification



6.Dimension (Unit/mm) :

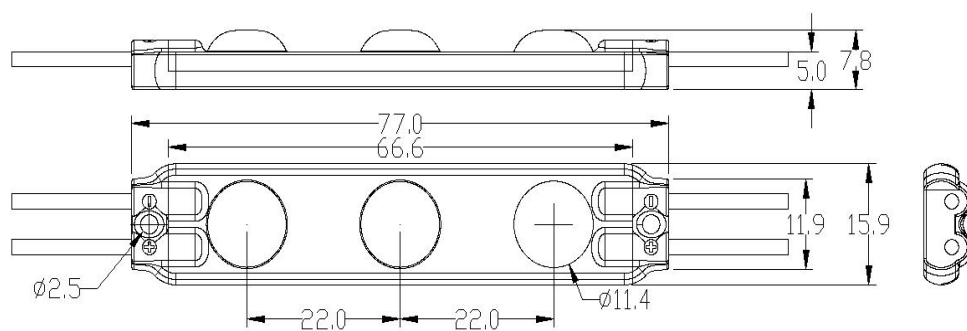

7.Connection Layout

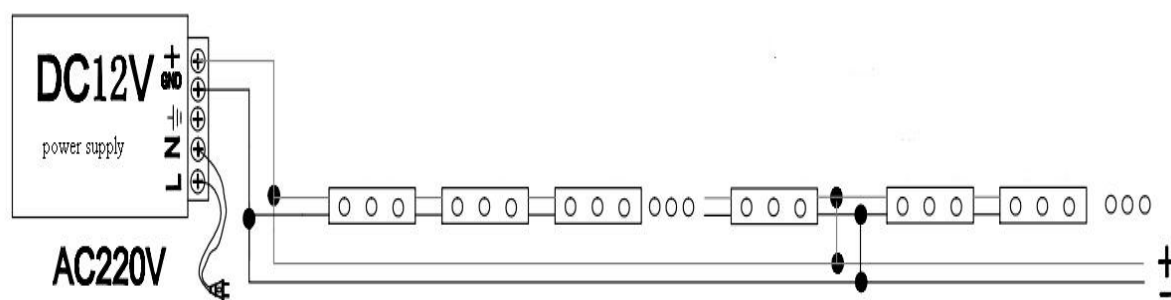

Power

Main power line

8. Installation:

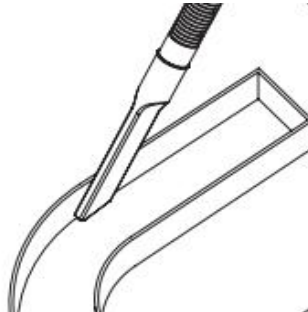

- Clean & remove all debris from the inside of the signage before you begin

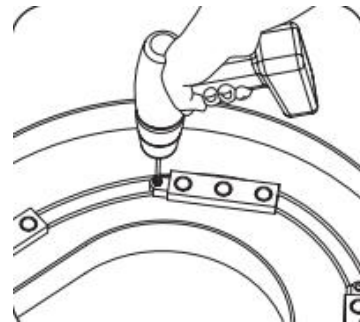
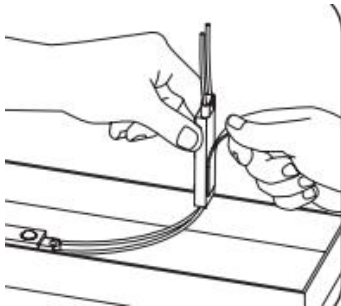

- Remove tape backing and stick LED modules into place. Potting glass glue on both side of led module or screwing is recommended as security. Use screws, or silicone to secure at least every fifth LED module within the channel letter.

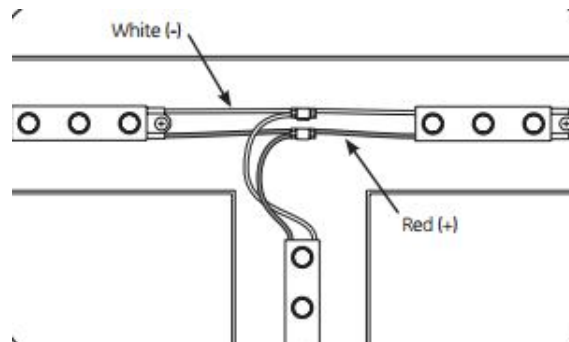

- Connect different lines of led module together.
 - (1) Connect LED strips using in-line connectors or twist-on wire connectors
 - (2) cut from middle of led modules. Peel off 10mm cover from wire. Connect the red wire (+) of the LED to the red wire (+) of another led strip. Connect the white wire (-) of the LED strip to white wire (-) of the another led strip. Insulate the connections. Test wire connections by hand. It is qualified if you can not pull off by hand. Test wire connections by turn on power supply.

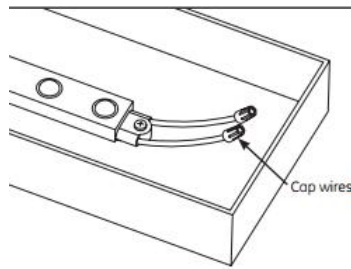

- Must cap all exposed wires with appropriate wire connectors

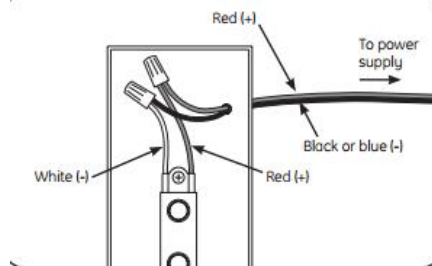

- The connections between led strips and power supply should be covered by silicone or glass glue to prevent from water and rot
- The Max series connection should be not over 20 when power supply run only from one side
- All electrical connections should be made within the Signage. Operate under turn off power
- Quality of power supply are strongly recommended to make sure the signage lighting last longer

9.Packing:

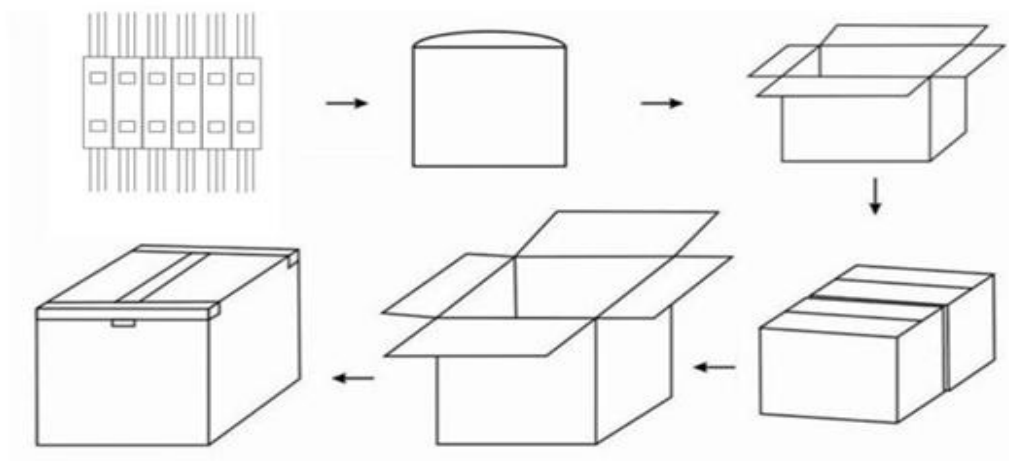

- 1500pcs/carton Carton Size: 500*350*315mm
- Net Weight: 21.5 (1±10%) kg; Gross Weight: 22.5 (1±10%) kg;
- The quantity and weight can be different if packing be changed



【Note】



- 1.Handle them with care
- 2.Can not be operated in in flammable and explosive place
- 3 .Operation should be under Turn off power
4. Can not be operated in place near heat source
- 5.Remove cover should be authorized
- 6.Any questions about led module. Please feel email us to get professional advice